

Spray Polyurethane Foam (SPF) and Cathedral Roofs & Cathedralized Attics



This document was developed to aid in the use of SPF in Cathedral roof/attic applications. The information provided herein, based on current customs and practices of the trade, is offered in good faith and believed to be true, but is made WITHOUT WARRANTY, EITHER EXPRESS OR IMPLIED, AS TO FITNESS, MERCHANTABILITY, OR ANY OTHER MATTER. APC DISCLAIMS ALL LIABILITY FOR ANY LOSS OR DAMAGE ARISING OUT OF ITS USE. Individual manufacturers and contractors should be consulted for specific information. SPFA does endorse the proprietary products or processes of any individual manufacturer, or the services of any individual contractor. APC does not endorse the proprietary products or processes of any individual manufacturer, or the services of any individual contractor.

To order copies of this publication, call 800-243-5790 and request SPFA Stock Number AY-141

Spray Polyurethane Foam Alliance
Copyright January 2003

BUILDING ENVELOPE COMMITTEE (BEC)

Mission Statement

To provide a technical basis for expanding the use of polyurethane-foam-in-place within the building envelope.

To achieve this mission, the BEC will review and support the development of methods for performance evaluation of SPF, participate in activities leading to development, documentation and dissemination of information on applications of SPF in different building envelopes and systems.

To participate in the planning, organizing, documenting and supporting of construction and monitoring of selected demonstration projects with SPF in the building envelope.

To assist the Management and IPC committees in developing and carrying out market oriented programs.

BUILDING ENVELOPE COMMITTEE

Neal Ganser, Chairman
Corbond Corporation
32404 East Frontage Road
Bozeman, MT 59715
406-586-4585
Fax: 406-586-4584
nganser@corbond.com

Bill Amend
Foam Enterprises, Inc.
13630 Watertower Circle
Minneapolis, MN 55441
800-888-3342
Fax: 612-559-0945
Bill_Amend@
foamenterprises.com

Robert Braun
The Dow Chemical Company
2050 N. Broadway
Joliet, IL 60435
815-741-6800
Fax: 815-741-6822
bgbraun@dow.com

John Courier
Equipment & Coatings Technology
19815 98th Avenue South
Renton, WA 98055
253-850-8709
Fax: 253-850-8702
johnpc@email.msn.com

Tom Harris
BASF
1609 Biddle Avenue
Wyandotte, MI 48192
734-324-5317
Fax: 734-324-6482
harristr@basf.com

Roger Morrison
NCFI
1515 Carter Street
Mount Airy, NC 27030
336-789-9161
Fax: 336-789-9586
Roger.Morrison@ncfi.net

Mary Ellen Mueller
Convenience Products
866 Horan Drive
Fenton, MO 63026-2416
636-349-5333
Fax: 636-349-5335
memsl@claytoncorp.com

Tom Shackelford
Pecora Corporation
165 Wambold Road
Harleysville, PA 19438
800-355-8817 ext.6109
Fax: 480-898-1586
shackelfordt@pecora.com

John Stahl
Preferred Solutions, Inc.
7819 Broadview Road
Cleveland, OH 44131
216-642-1200
Fax: 216-642-1166
John.Stahl@stayflex.com
AD-HOC Members:

Ad Hoc Members

Laverne Dalglish
CUFCA
PO Box 3214
Winnipeg, Manitoba
CANADA R3C 4E7
204-956-5888
Fax: 204-956-5819
C- 204-771-7351
Ldalglish@bpa.ca

Mort Sherman
consultMORT, Inc.
6723 14th Avenue N.
St. Petersburg, FL 33710
727-343-2079
Fax: 727-347-7346
msherman@tampabay.rr.com

Anthony Woods
Can-Am Bld. Env. Specialists
125 Traders Blvd. East, #4 Mississauga, Ontario
CANADA L4Z 2H3
905-890-5866
Fax: 905-890-8114
twoods@canambuildingenvelope.com



Spray Polyurethane Foam (SPF) And Cathedral Roofs & Cathedralized Attics

Closed cell, spray polyurethane foam (SPF) may be used to construct unvented cathedral roofs and cathedralized attics. It can be applied in sufficient thickness to satisfy local energy code requirements, directly to the underside of roof sheathing between rafters or joists of any slope in all (heating, mixed and cooling) climates.

This configuration controls the entry of moisture-laden air into the insulation and also eliminates dew-point occurring at the underside of the roof deck and anywhere in the insulation, in all (heating, mixed or cooling) climates*. Due to the fully adhered, closed cell properties of SPF, air and moisture are displaced out of the insulated space – including at rafters and sheathing. Moisture cannot enter the insulated space from any direction, eliminating the requirement for roof venting.

Venting above the closed cell SPF could reintroduce moisture laden air into a new air space below the roof sheathing, which may introduce another moisture condensation problem. Therefore, venting above the SPF in these configurations is not recommended.

*(Assumes the suitable thickness of SPF is applied to prevent condensation)

Spray Polyurethane Foam Alliance
1300 Wilson Blvd.
Arlington, VA, 22209
800-523-6154

CATHEDRAL ROOF DETAIL

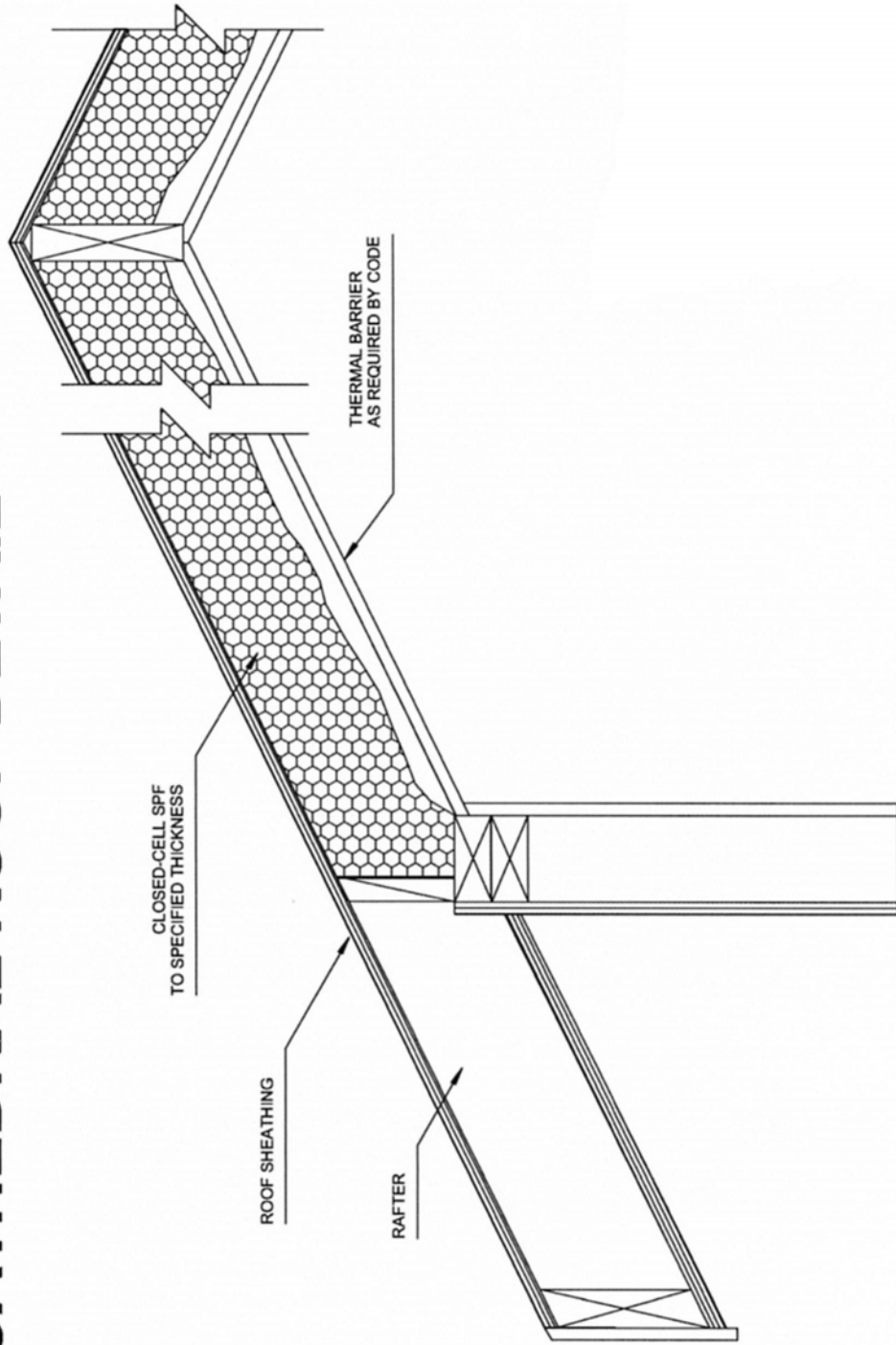

CATHEDRALIZED ATTIC DETAIL

NOTE: IN COLD CLIMATES, EMBED METAL CONNECTOR PLATES IN SPF TO PREVENT WINTER-TIME CONDENSATION.

